

CS Corrimano massiccio sagomato mm. 60x70 per colonne in legno

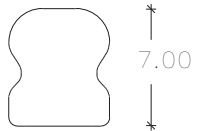

CS Corrimano massiccio sagomato mm. 60x70 per colonne in ferro forgiato, alluminio o acciaio

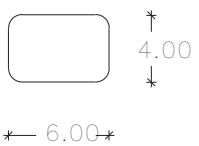

CB Basamento massiccio mm. 60x40 per colonne in legno, ferro forgiato, alluminio o acciaio

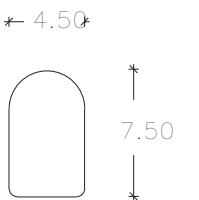

CL Corrimano massiccio liscio mm. 45x75 per colonne in ferro forgiato, alluminio o acciaio

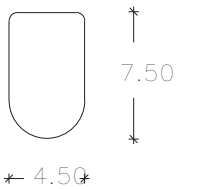

CL Basamento massiccio liscio mm. 45x75 per colonne in ferro forgiato, alluminio o acciaio

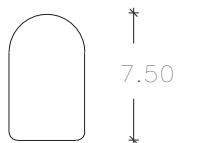

CI Corrimano impiallaciato mm. 45x75 per colonne in ferro forgiato, alluminio o acciaio



CH Corrimano a muro massiccio mm. 60x40



CC Corrimano a muro massiccio diametro mm. 50



CCI Corrimano a muro impiallaciato diametro mm. 45



ATT Attacco per corrimani a muro

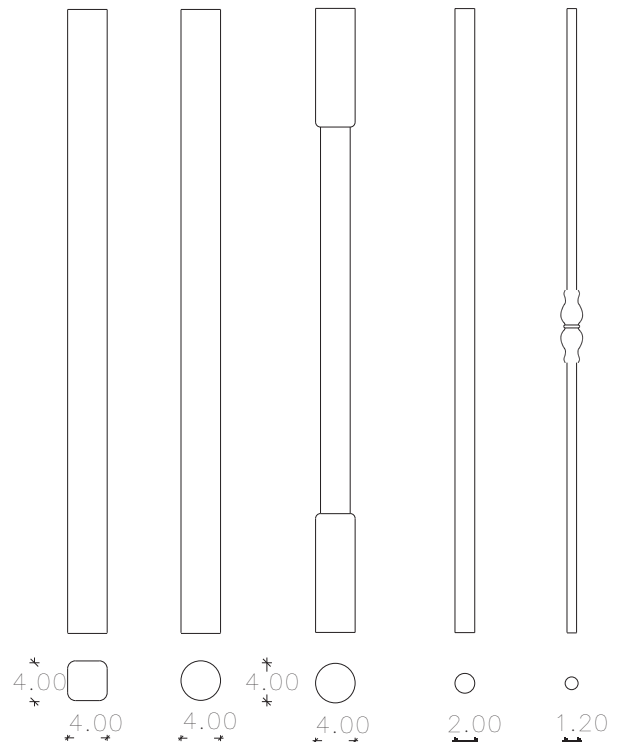
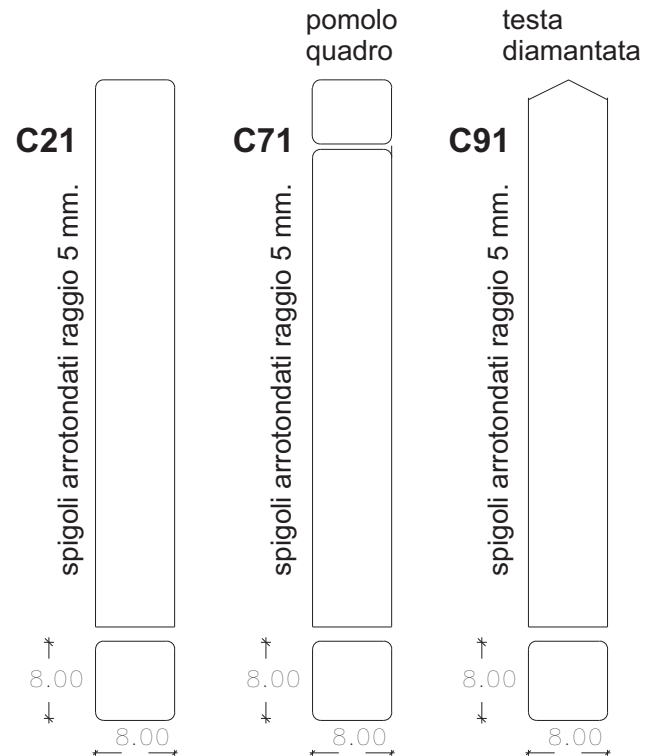

C22 **C32** **C32A** **CAL** **CAC** **CFF**

C21/C71/C91 Caposcala mm.80x80
C22 Colonna in legno mm.40x40
C32 Colonna in legno \varnothing 40
C32A Colonna in legno doppio diametro
CAL Colonna in alluminio \varnothing 20
CAC Colonna in acciaio \varnothing 20
CFF Colonna in ferro forgiato \varnothing 12